



Accessibility Overview

December 2024



Summary

This document contains current accessibility bugs in Glean and provides more detailed information about each one. Each WCAG category has a status and each item within that category also has a status.

Status Legend

- Scheduled - Issue has been scheduled to be fixed in the target quarter
- Validation - We are waiting for our fix to be tested and validated by LevelAccess
- Partially Fixed - Issue has been partially resolved or the impact has been reduced
- Fixed - Issue has been fully resolved

1.3.1 Info and Relationships

Status: Partially Fixed

Field Labels

Status: Scheduled Q4 2024

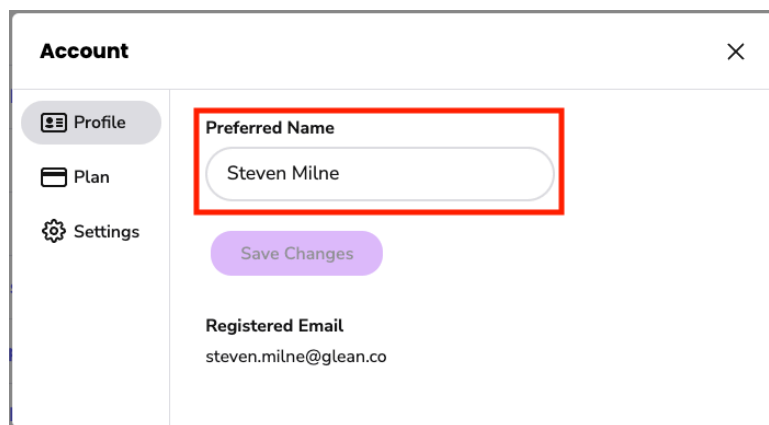

The preferred name field in the account popup is not programmatically associated with its field label. Instead the label is provided using the `aria-label` attribute.

This results in screen reader users hearing the field label twice. Below is an example announcement from VoiceOver on macOS;

Preferred Name

Steven Milne, insertion at end of text, Preferred Name, required, edit text

People impacted;

- People using a screen reader

Using Placeholders as Field Labels

Status: Scheduled Q4 2024



The image shows the Glean logo, which consists of a black teardrop shape with a white circle inside, followed by the word "Glean" in a bold, sans-serif font.

Below the logo is a sign-in form. It features two input fields: "Email" and "Password". The "Email" field is a simple rounded rectangle with the placeholder text "Email". The "Password" field is a rounded rectangle with the placeholder text "Password" and a blue eye icon on the right side, indicating a password toggle. Below these fields is a black button with the text "Sign in" in white.

Many fields in Glean do not have a dedicated label and instead use the placeholder text as a label.

Using placeholder text as a label means that the label is no longer visible once text has been entered into the field. This means that a person must remember which field is which, if they forget they are forced to delete the value of a field to see the placeholder again.

People impacted;

- People with cognitive impairments

Implicit List Markup

Status: Partially Fixed

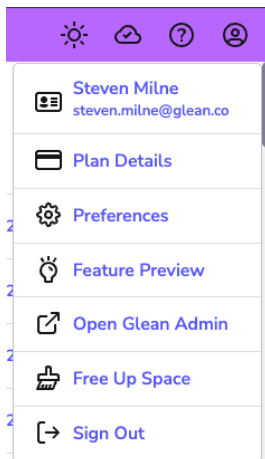
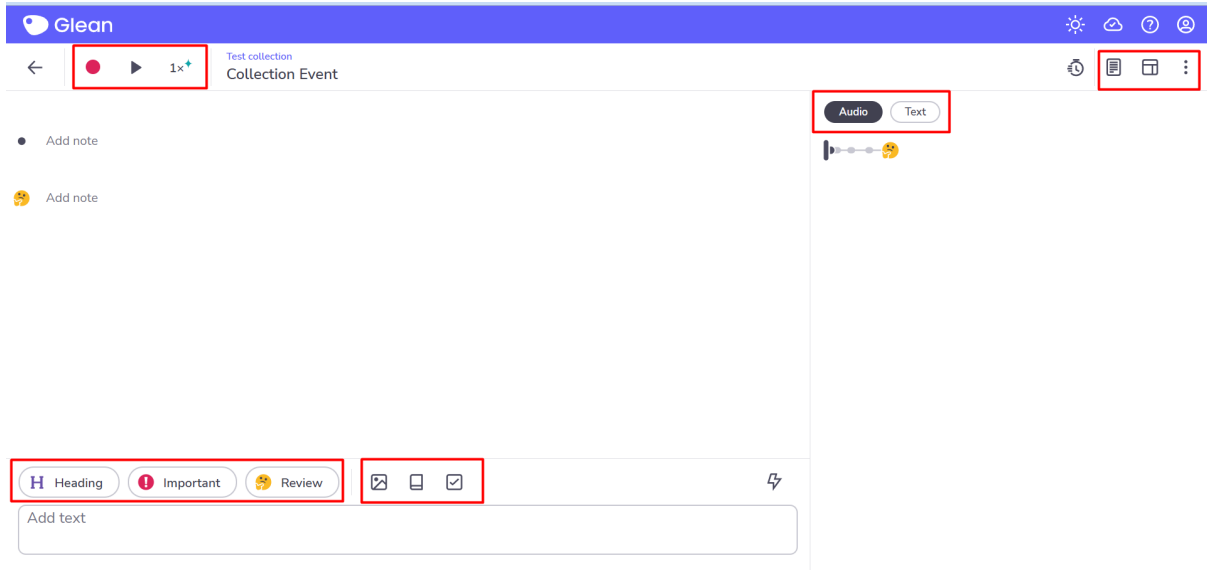

Some dropdown menus and some toolbars are not marked up as lists in Glean.

Marking these up as lists gives extra announcements to screen readers so that they are aware of how many items are in the list. Screen readers also have extra navigation features for jumping around lists and skipping items. Currently a person using a screen reader would not know how many items are in a dropdown until they have navigated to each item.

People impacted;

- People using screen readers

3.3.2 Labels or Instructions

Status: Scheduled Q4 2024

Sorting Options

Status: Scheduled Q4 2024

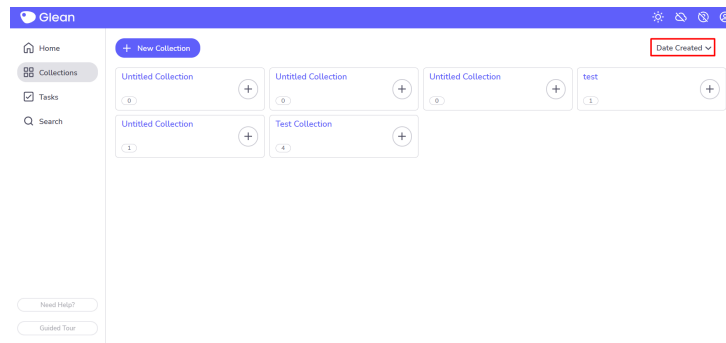

The sorting options picker shown on the collections page and tasks panel do not show visible labels. Instead the value is used to suggest the purpose.

This means that people will need to use context to determine what this field does. People who use voice control will not know the name of the field which prevents them from interacting with it.

People impacted;

- People who use voice control
- People with cognitive impairment

Toolbar Buttons and Dropdowns

Status: Scheduled Q4 2024

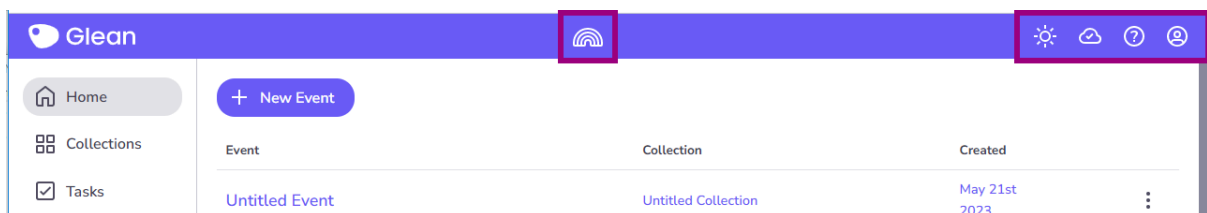

The dropdown and toggle buttons on the main navigation bar do not show visible labels. People who use voice control will not know the name of the button which prevents them from interacting with it.

People impacted;

- People who use voice control

4.1.2 Name, Role, Value

Status: Partially Fixed

Event Page

Status: Scheduled Q4 2024

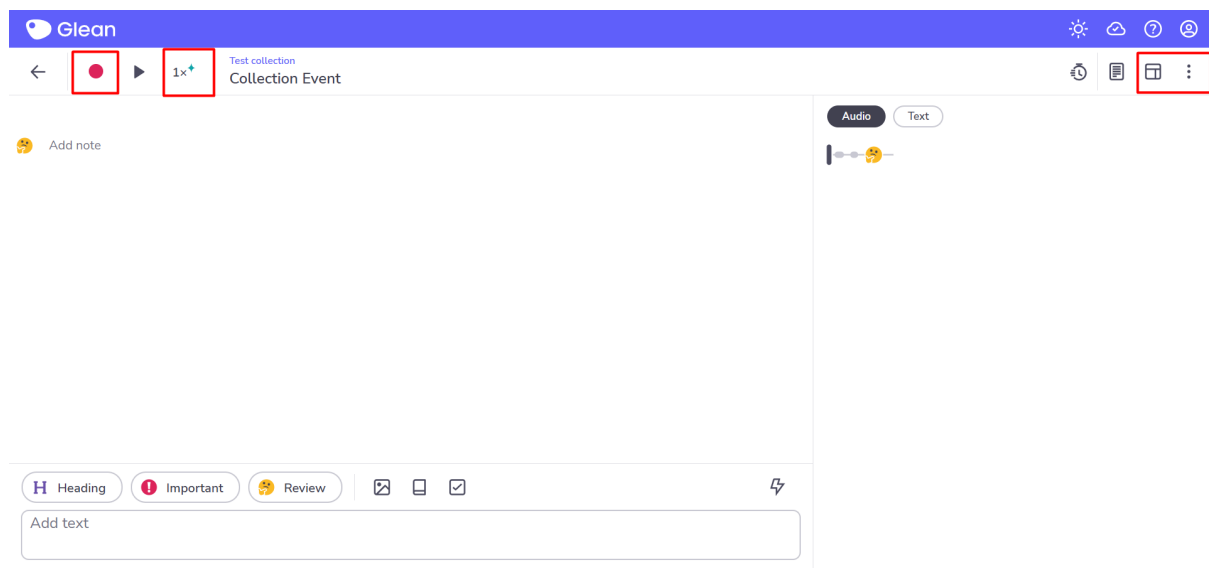

The dropdown menus on the event page do not communicate that they open a menu when clicked or even if the menu is open. This means a screen reader user will not be aware that a button opens a dropdown menu before they click it.

People impacted;

- People who use screen readers

1.4.10 Reflow

Status: Partially Fixed

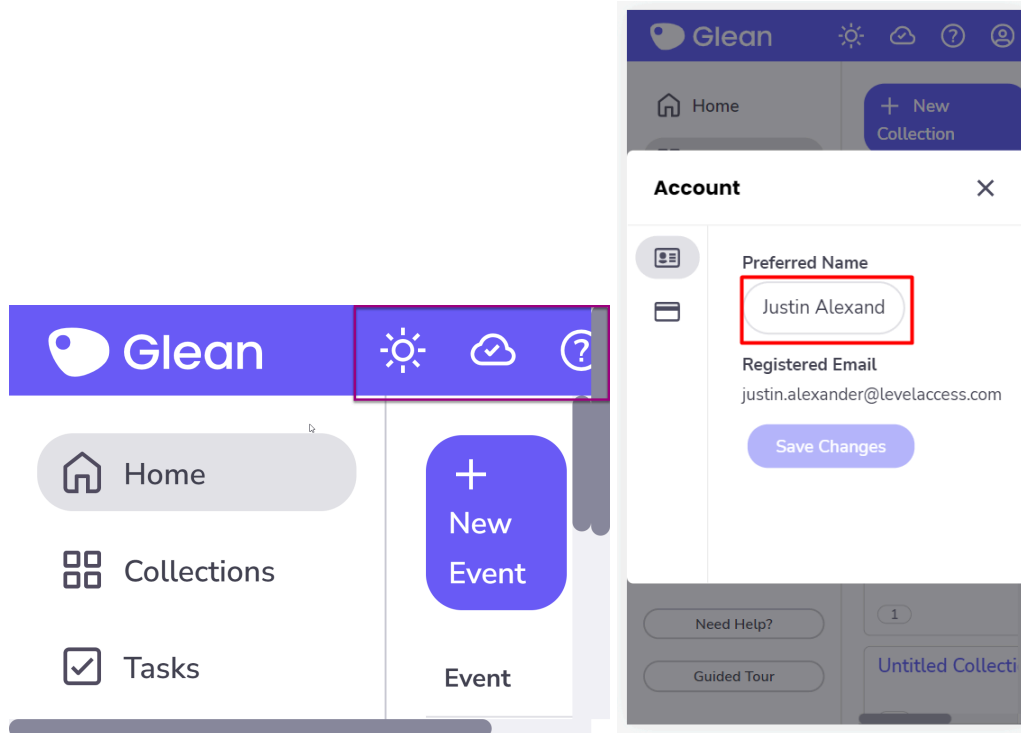

Some screens in Glean do not reflow enough to support a screen width of 320 pixels.

This means that users of such small screens will need to use both horizontal and vertical scrolling to see and use all content. In some cases fields will be too small to see the full value if that value is long.

People impacted;

- People with low vision who need significant amounts of zoom

1.4.11 Non-text Contrast

Status: Partially Fixed

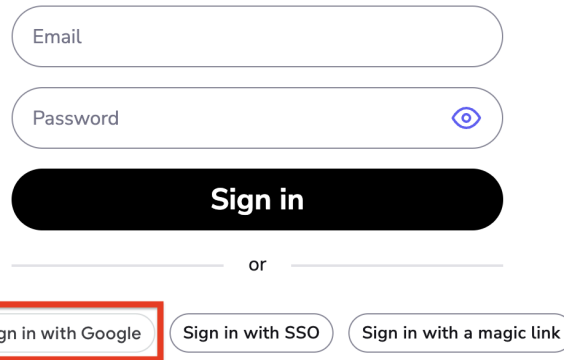

The “Sign in with Google” button does not meet colour contrast requirements of 3:1 on its borders.

This means that people who have low vision may not see where the button starts and ends which can make it difficult to click on or interact with the mouse.

People impacted;

- People with low vision who do not use a screen reader
- Anybody using the app in a bright environment

1.4.12 Text Spacing

Status: Scheduled Q4 2024

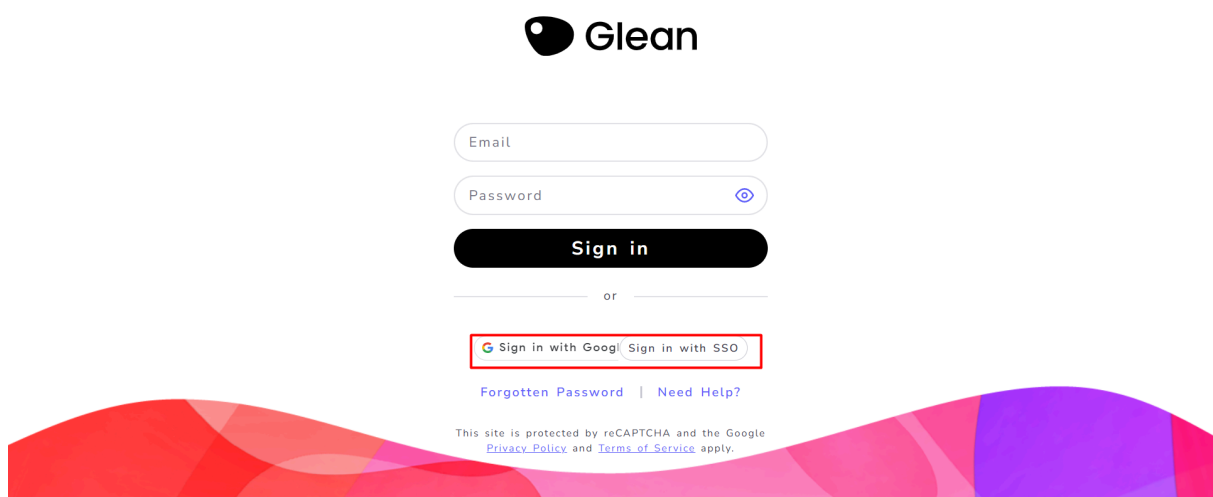

The “Sign in with Google” button on the login screen will overflow and hide behind other content when text spacing is increased.

This makes it difficult to understand what the button does as part of its label will be cut off.

People impacted;

- People with low vision
- People with dyslexia